

Materiale: 1.2344 niturato

Material: 1.2344 nitrided

Werkstoff: 1.2344 Nitriert

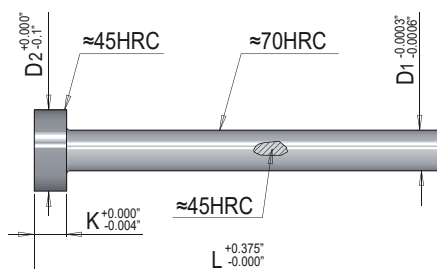

Codice	D1	D2	K	L				
				6"	10"	14"	18"	25"
EX3M	3/64"	1/4"	1/8"	•				
EX5M	1/16"	1/4"	1/8"	•				
EX6M	5/64"	1/4"	1/8"	•				
EX7M	3/32"	1/4"	1/8"	•	•			
EX8M	7/64"	1/4"	1/8"	•				
EX9M	1/8"	1/4"	1/8"	•	•	•		
EX11M	5/32"	9/32"	5/32"	•	•	•		
EX13M	3/16"	3/8"	3/16"	•	•	•	•	
EX15M	7/32"	13/32"	3/16"	•	•	•	•	•
EX17M	1/4"	7/16"	3/16"	•	•	•	•	•
EX19M	9/32"	7/16"	1/4"	•				
EX21M	5/16"	1/2"	1/4"	•	•	•	•	•
EX23M	11/32"	9/16"	1/4"			•		
EX25M	3/8"	5/8"	1/4"	•	•	•	•	•
EX29M	7/16"	11/16"	1/4"	•	•	•	•	•
EX33M	1/2"	3/4"	1/4"	•	•	•	•	•
EX37M	5/8"	7/8"	1/4"	•	•	•	•	•
EX41M	3/4"	1"	1/4"	•	•	•	•	•
EX47M	1"	1" 1/4	1/4"	•	•	•	•	•

Esempio d'ordine: Codice x L**Order example:****Bestellbeispiel:**